

Number 7 Meter Service Dual Check Valve

Description

The Reliance No 7 Meter Service Dual Check Valve Range delivers proven performance in a proven design. The No 7 range comes in sizes from 20mm to 32mm, and are designed with optimised headloss characteristics, to ensure minimised headloss.

The Reliance No 7 Dual Check Valve Range provides cost effective product solution for low hazard backflow protection on 20mm to 32mm water services.

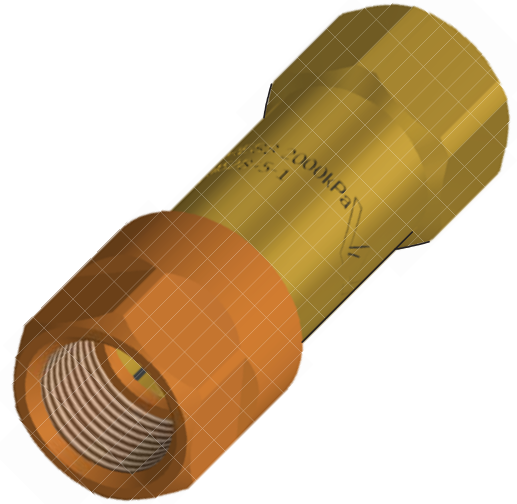

Features and Benefits

- ❖ Solid build quality
- ❖ Field Serviceable check valve inserts
- ❖ Approved to Watermark AS2845.1
- ❖ Long life performance, through its high quality components.

Specification

Maximum Operating Temperature	60° C
Maximum Operating Pressure	1400 kPa
Inlet/Outlet Fittings	¾" BSP (FI)
Installation Orientation	Horizontal or Vertical

Dimensions

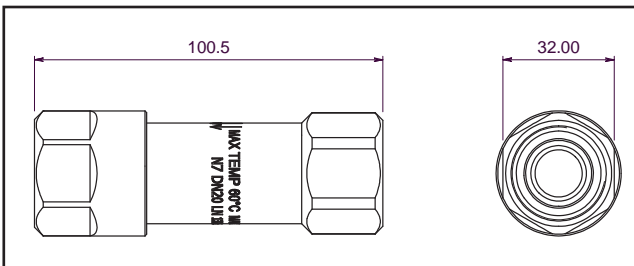

Materials

Housing	35200 Brass, DZR to AS2345
Internal Components	Acetal copolymer/Viton